



GENERAL DATA	
Equipment / System name:	Multipurpose hydraulic press
Equipment / System number:	-
Alias:	MHPress
Location:	Building INTA B-14
Picture(s):	<p>Shielding Effectiveness (SE) measurement according to ASTM D4935</p>  <p>DC square resistance measurement of multi-ply CFCs</p> 

TESTING CAPABILITIES	
Types of tests that can be carried out in the Facility	<p>Shielding Effectiveness (SE) measurement according to ASTM D4935</p> <p>DC square resistance measurement of multi-ply CFCs</p>
Maximum dimensions of the equipment under test	<p>SE Measurement according to ASTM D4935: The dimensions of the specimen holder are defined in the standard (see figure 1)</p> <p>DC square resistance measurement of multi-ply CFCs: 200 x 200 mm</p>
Restrictions / Limitations	N/A
Remarks	The entire system is placed into a commercial pneumatic press, MEGA PRC-20 with a nominal force of 20 Tons.

TECHNICAL CHARACTERISTICS	
Test frequency	SE Measurement according to ASTM D4935: 30 MHz to 1,5 GHz DC square resistance of multi-ply CFCs: DC
SE measurements	A vector network analyzer (VNA) has been used to generate and receive the radiofrequency signal.
Military / civil / space standards for SE measurements	ASTM D4935
DC square resistance measurements	To measure the electrical resistance, a micro-ohmmeter (model 580 from Keithle, is used. This unit is designed for low resistance measurement requirements from 10 $\mu\Omega$ to 200 k Ω .

DRAWINGS / SCHEMES (if applicable)

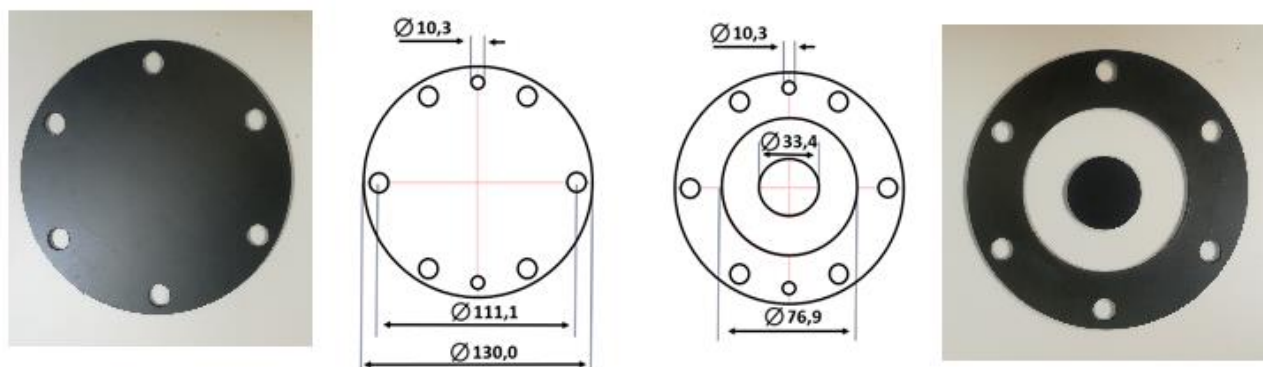

Figure 1. Load (left) and reference (right) samples. Dimensions in mm. ASTM D4935 standard.